

Ceiling Lift - Fixed

V4

# PRODUCT	DESCRIPTION	MARKET
#9100001	V4 / 4 Way - KWIKtrak	NORTH AMERICA
#9100004	V4 / 4 Way - KWIKtrak	AUSTRALIA
#9100008	V4 / 4 Way - KWIKtrak	EUROPE & UNITED KINGDOM
#9100029	V4 / 4 Way - KWIKtrak - Wireless (I.R. remote)	ALL MARKETS
#9101001	V4 / 4 Way - BHM Track	NORTH AMERICA
#9100209	V4 / 2 Way - KWIKtrak	ALL MARKETS

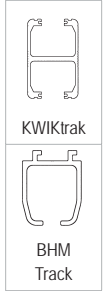

Lifting capacity :
440 lb / 200 kg / 31.49 st

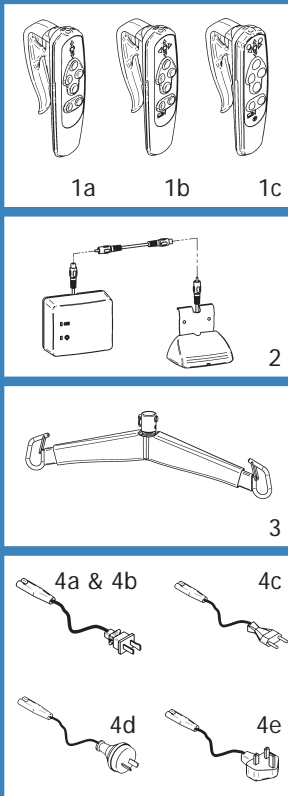

√ = Included / 0 = Optional

# PART	DESCRIPTION	#9100001	#9100004	#9100008	#9100029	#9101001	#9100209
1a	#700.13600 Hand Control - 2 Way						√
1b	#700.13650 Hand Control - 4 Way	√	√	√	√	√	
1c	#700.13640 Hand Control - Wireless (I.R. Remote)				√		
2	#700.15500 Charging Station - KWIKtrak	√	√	√	√		√
2	#700.15507 Charging Station - BHM Track					√	
2	#700.15505 Center Track Charger - BHM Track					0	
3	#700.05490 Carry Bar	√	√	√	√	√	√
4a	#402.00001 Charger Power Cord - North America	√			√	√	√
4b	#402.00002 Charger Power Cord - Japan				√		√
4c	#402.00003 Charger Power Cord - Europe			√	√		√
4d	#402.00004 Charger Power Cord - Australia		√		√		√
4e	#402.00005 Charger Power Cord - United Kingdom			√	√		√

SUGGESTED SLINGS & STRETCHERS	Hammock & Hammock 6	Hygienic	Quick Fit	Band	Chest	Total transfer	Combi	Repositioning	Bariatric	Walking	Soft	Universal	Margue
	Slings											Stretchers	
	√	√	√				√	√	√	√	√		√

(For more details, look into the Sling Section)

FEATURES

Weight	12.7 kg / 28 lb / 2 st
Lifting capacity	200 kg / 440 lb / 31.49 st
Soft start & stop movement	
Return to charge function on handset	Lift cannot return to charger with load

SAFETY FEATURES

Emergency lowering device	Manual & electric
Emergency brake	Prevent free fall
Emergency Stop Pull Cord	

TECHNICAL SPECIFICATIONS

CSA, UL & CE approved	
Vertical displacement speed	6 cm/sec (2.4 in/sec) at 200 kg / 440 lb / 31.49 st
Horizontal displacement speed - Programmable	10, 15, 20 or 25 cm/sec (3.9, 5.9, 7.9 or 9.8 in/sec) Default : 20 cm/sec (7.9 in/sec)

BATTERY SPECIFICATIONS

Rechargeable sealed lead acid	(2X) 12VDC, 5Ah
Side rail mounting, position anywhere, charging system	
Battery capacity with load of 91 kg / 200 lb / 14.33 st	Up to 120 transfers
Low battery warning indicator - Visual & audible	
Charger input - 90-240 Vac, 50-60 Hz, 27 VA max.	
Charge indicator - Visual	

STRAP SPECIFICATIONS

Length	2.3 m (90½ in)
Automatically stops unit if twisted	
Tested for 2727 kg / 6000 lb / 429.4 st	

UNIT CONSTRUCTION

Frame - high strength rolled steel zinc plated	
Cab - fire retardant plastic	

COMMON SPARE PARTS

A	#362.14000	V4 - Strap
B	#492.00035-1	V4 (440 lb) Main Board
C	#403.10500 (X2)	Battery

ACCESSORIES

D	#402.15505	Charger extension - 2 m (78 in)
E1	#700.00510	Scale Unit (North America, Japan, & Australia)
E2	#700.00530	Scale Unit - Class III (Europe & United Kingdom)

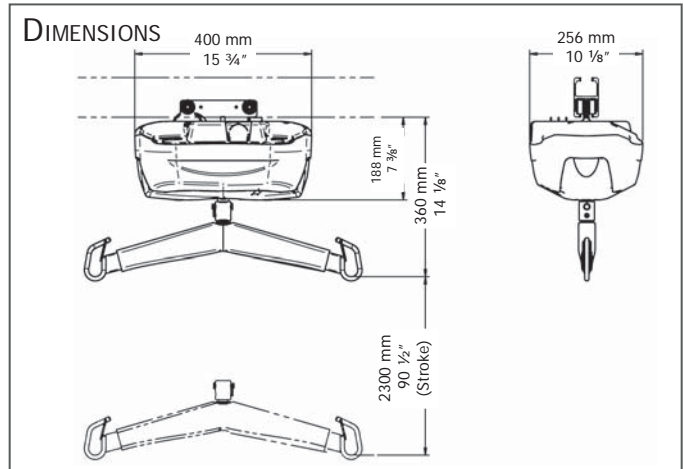
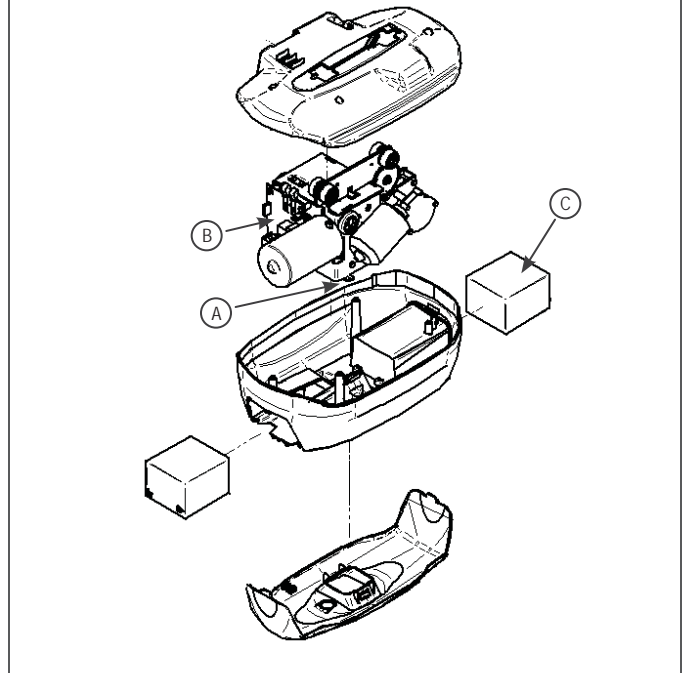
EXPLODED VIEW

ACCESSORIES
